



- 1 Hip Width _____
- 2 Widest Point _____
- 3 Thorax Width _____
- 4 Knee to Heel _____
- 5 SRP to Knee _____
- 6 Elbow to SRP _____
- 7 Shoulder Height _____
- 8 Occipital Height _____

CARBORUN



Measurements Guide

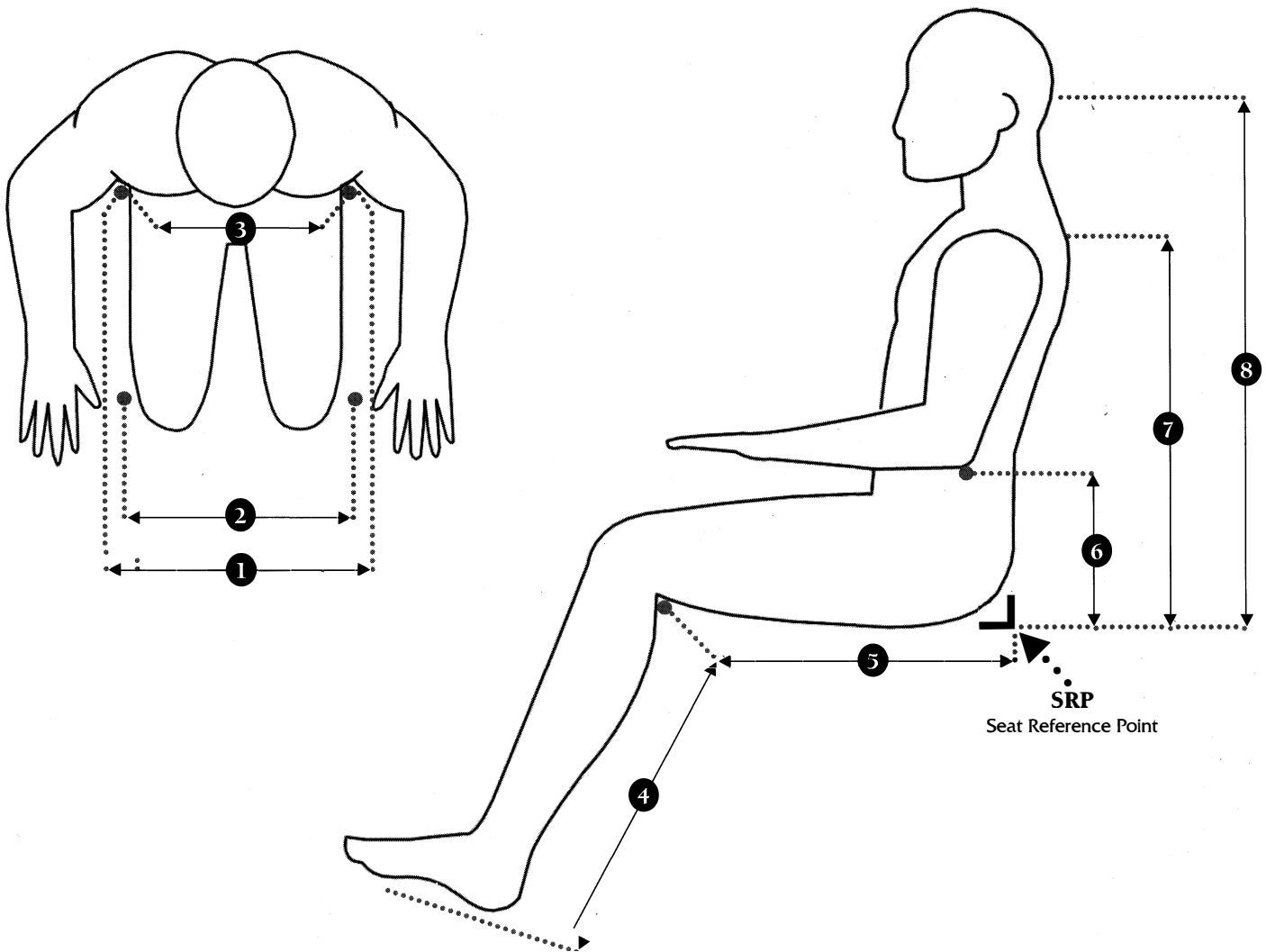

CARBORUN



TECHNICAL DATA



SW: 36 – 45 cm
in increments
of 3 cm



SD: 38 – 44 cm
in increments
of 2 cm



FD: 33 – 43 cm
in increments
of 2 cm



BA: 85° – 100°
in increments
of 5°



TOTAL WIDTH:
approx
SW + 18 cm



TOTAL LENGTH:
approx
85 – 100 cm



SH: fixed
front: 47 cm
rear: 43 cm



BH: 25 – 45 cm
in increments
of 5 cm



CAMBER:
0° or 2°



TOTAL WEIGHT:
approx
8 kg



TRANSPORT
WEIGHT:
approx
5.1 kg



MAX USER
WEIGHT:
130 kg



REAR WHEEL:
24 inch



FRONT WHEEL:
3/4/5 inch



SIDE GUARD:
carbon fiber



CARBON FIBER:
frame / foot plate
/ side guard

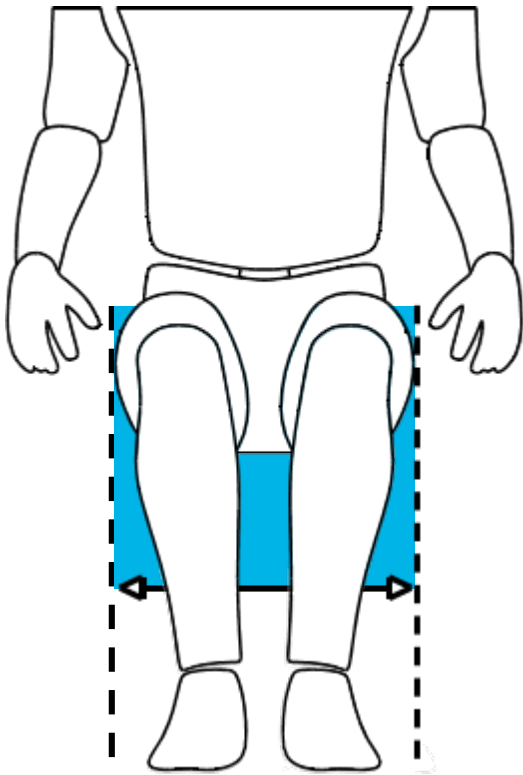

SEAT WIDTH

The seat width determine the user's comfort and performance. It must be wide enough to ensure good weight distribution but narrow enough to allow easy manipulation of the wheelchair.

1. Let the person sit on a flat surface
2. Measure between the internal faces of the side guards
3. Add approximately 1cm to cater for winter clothing for the wheelchair measurement.
4. The result is the choice on the order form.

Not adjustable
after sale. Please
!make attention

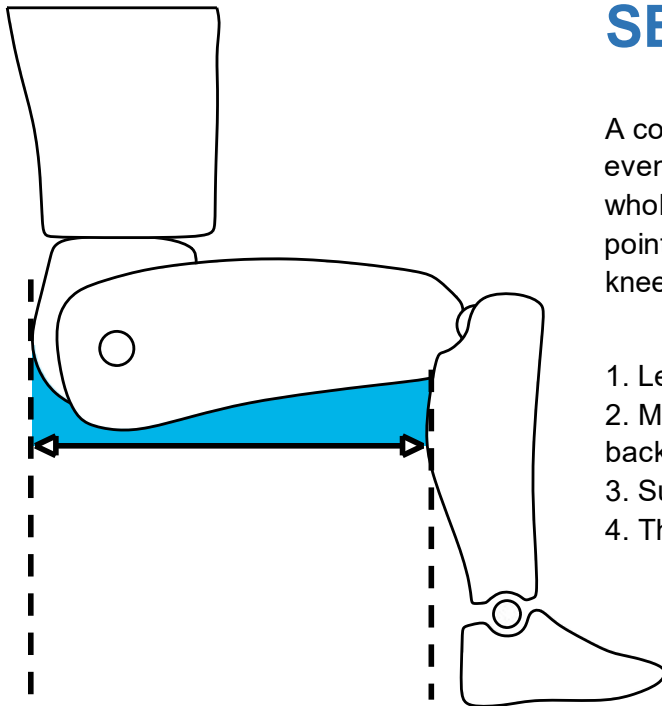

SEAT DEPTH

A correct seat depth measurement enables an even distribution of the user's weight across the whole seating base, thereby avoiding pressure points and skin irritation in the area behind the knee.

1. Let the person sit on a flat surface
2. Measure the distance from the back to the hollow at the back of the knee.
3. Subtract at least 5 cm to give the wheelchair measurement.
4. The result is the choice on the order form.

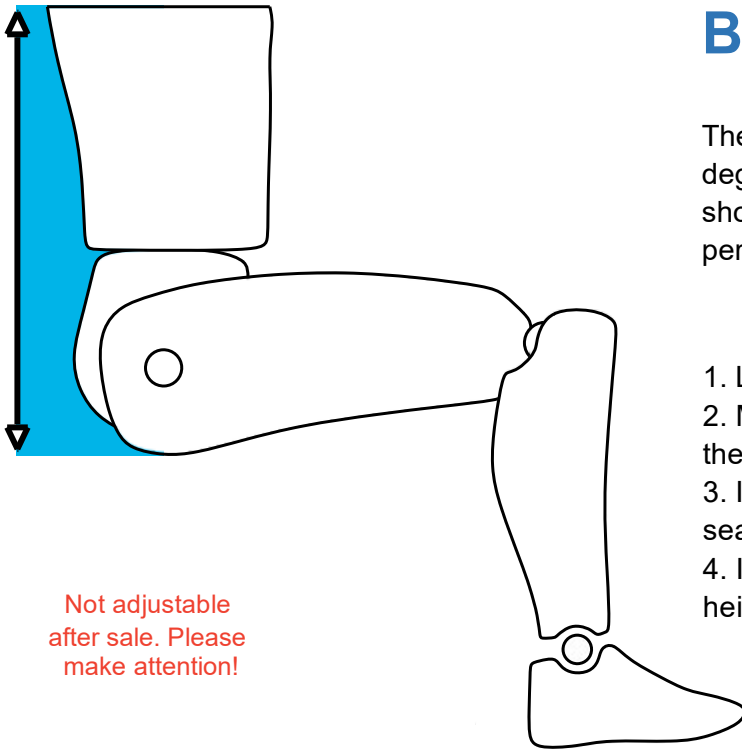

Not adjustable
after sale. Please
make attention!

BACKREST HEIGHT

The backrest height is dependent on the user's degree of disability. A correct backrest height should maintain a good posture whilst allowing the permitted freedom of movement.

1. Let the person sit on a flat surface
2. Measure the vertical distance from the seat plate to the scapulas.
3. If more trunk support is required, measure from the seat plate up to the required level of support.
4. If less trunk support is required reduce the backrest height in order to improve activity.

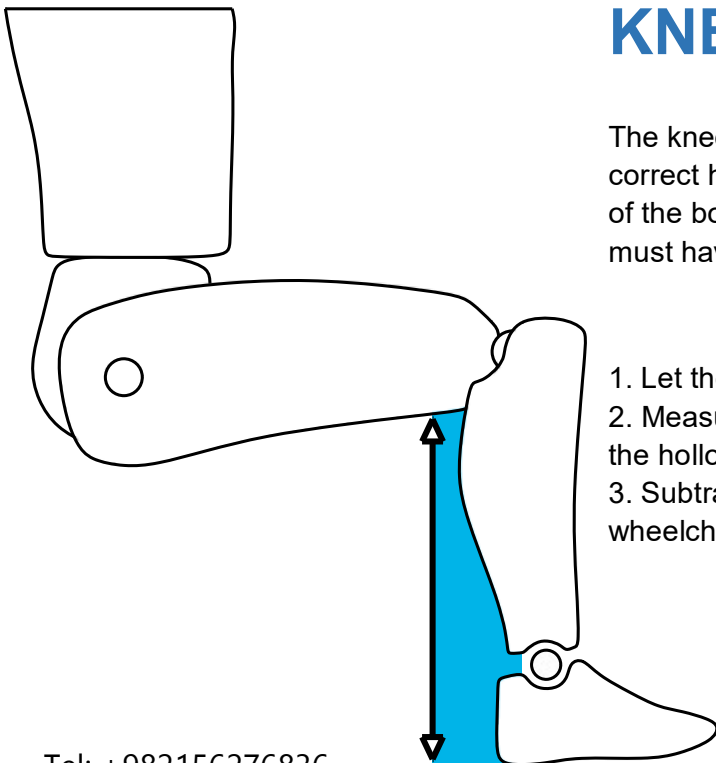

KNEE TO HEEL LENGTH

The knee to heel length measurement determines the correct height for the footrest, which will enable part of the body weight to be taken by the feet. Footrest must have at least 3 cm clearance above the ground.

1. Let the person sit on a flat surface
2. Measure the distance from the heel to the shoe to the hollow at the back of the knee
3. Subtract any cushion thickness to give the wheelchair measurement